

## CARE Series

# 3052 WALK-IN TUB

The American Tubs 3052 from our CARE Series provides a luxury spa experience from the comfort of your own home.

Boasting a 40" high tub basin, the 3052 allows for deeper upper body water immersion while maintaining a compact footprint for almost any bathtub or shower space. Its overall size and 20½" seat make the 3052 the perfect size for narrow, 60" bathrooms while being large enough to accommodate individuals between 120-250 lbs.

The 3052 remains one of American Tubs top performers.



### THERAPEUTIC SYSTEM OPTIONS



**Hydromassage System - 10 Jet**



**Air Massage System - 20 Jet**



**MicroBubble Skin-Cleansing System**

### DOOR/DRAIN ORIENTATION

Left-Hand or Right-Hand



### AVAILABLE COLORS

White or Biscuit



### STANDARD FEATURES

- Marine-Grade Fiberglass & Resin Composite Tub Shell
- High-Gloss, Triple-Coated Gelcoat Finish
- One-Piece, Stainless-Steel Support Frame
- 6 Adjustable Leveling Legs
- Low, 6" Door Threshold
- Ergonomic, Curved Door Handle
- Water-Tight Door Seal
- 17" High, ADA-Compliant, Contoured Seat
- Interior Safety Grab Bar
- Deck-Mounted, U-Shaped Grab Bar
- Non-Slip, Textured Floor
- Integrated Door Drain
- 2 Integrated Front Access Maintenance Panels
- Color-Matched Extension Kit to Fill to 60"
- Flangeless Design

American Tubs

1274 E Cypress St, Covina, CA 91724

Telephone: 626.581.3588

Fax: 800.943.8652

E-mail: [sales@americantubs.com](mailto:sales@americantubs.com)

© 2019 American Tubs

[AmericanTubs.com](http://AmericanTubs.com)

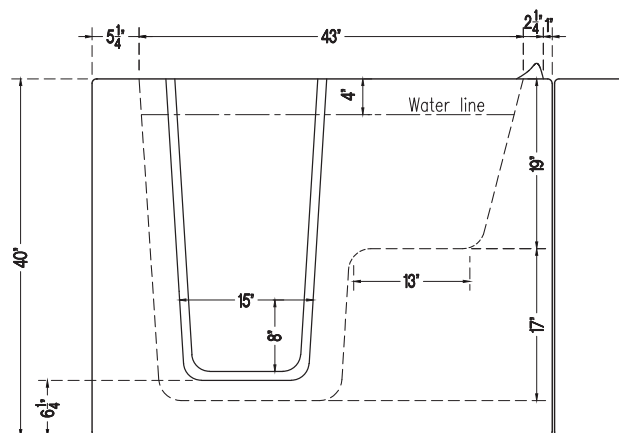
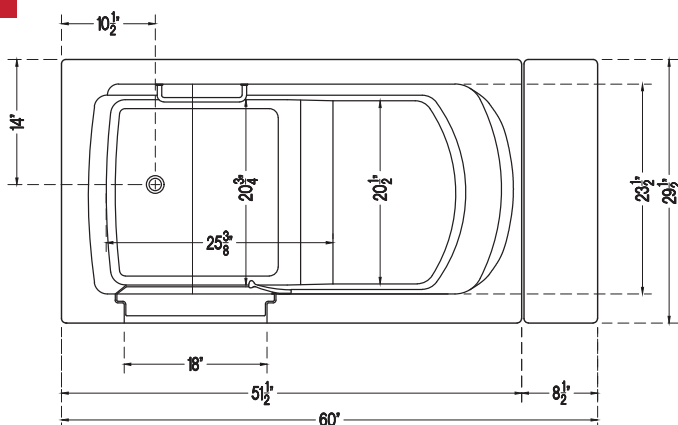

## TUB 3052 SPECIFICATIONS

Tub Dimensions	29½" W x 51½" L x 40" H
Top Diagonal	59½"
Tub Weight	165 lbs.
Crated Dimensions	32" W x 53" L x 50" H
Water Capacity (with user inside approximately)	120 lb. / 58 Gallons 200 lb. / 53 Gallons 250 lb. / 50 Gallons
Seat Dimensions	H: 17"; W: 20½"
Door Width	18" (at top)
Door Swing	Inward-Swinging

## DRAIN OPTIONS

1½" Bath Drain & Overflow
2" HurryDrain™
Secondary Emergency Drain
Power Drain

## FAUCET OPTIONS

Elite	4 pcs	Chrome	Modern
Bellevue	5 pcs	Chrome	Modern
Bellevue	5 pcs	Satin/Nickel	Modern
Bellevue	5 pcs	Oil-Rubbed Bronze	Modern
Salutation	5 pcs	Chrome	Classic
Kingston	1 pc	Chrome	Compact

## Hydromassage System Add-Ons & Upgrades

- Leg Massage Only System
- Adjustable Bidet Jet
- Ozone Sanitization System
- Water-Heating Syllent Pump
- Friction Heater
- Inline Heater
- Additional Hip or Knee Jets
- Aromatherapy System

## Optional Accessories

- Chromotherapy Light System
- Heated Seat & Backrest
- Neck Rest Pillow
- Seat Cushion
- L-Shaped Shower Curtain Rod
- Adjustable Shower Slide Bar
- Swinging Glass Shower Door
- Anti-Scald Valve
- Optional Tile Flange Kit
- Additional 12" Extension Kit
- End Panel for Seat and/or Faucet Side
- Bathing Support Harness



Plumbing Safety  
Certified



Electrical Safety  
Certified



Limited Lifetime  
Warranty



Expedited Freight Shipping  
(less than 2 weeks)



1274 E Cypress St, Covina, CA 91724

Telephone: 626.581.3588

Fax: 800.943.8652

E-mail: [sales@americantubs.com](mailto:sales@americantubs.com)

© 2019 American Tubs

