

## CARE Series

# 2646 WALK-IN TUB

The American Tubs 2646 from our CARE Series presents an elegant, safe and rewarding spa experience within a unique, space-saving design.

The 2646's compact width and length allows for easy maneuverability through narrow doorways, hallways, and perfectly fits in tight spaces.

This is the tub of choice for either petite users between 80-140 lbs. and shorter than 5'6" tall, or for installation in a 48" shower stall. This rare tub size enables even mobile homeowners and those with a three-quarter bath to recapture their independence.



### THERAPEUTIC SYSTEM OPTIONS



Hydromassage System - 10 Jet



Air Massage System - 20 Jet



MicroBubble Skin-Cleansing System

### DOOR/DRAIN ORIENTATION

Left-Hand or Right-Hand



### AVAILABLE COLORS

White or Biscuit



### STANDARD FEATURES

- Marine-Grade Fiberglass & Resin Composite Shell
- High-Gloss, Triple-Coated Gelcoat Finish
- One-Piece, Stainless-Steel Support Frame
- 6 Adjustable Leveling Legs
- Low, 6" Door Threshold
- Ergonomic, Curved Door Handle
- Water-Tight Door Seal
- 16" High, Contoured Seat
- Interior Safety Grab Bar
- Deck-Mounted, U-Shaped Grab Bar
- Non-Slip, Textured Floor
- Integrated Door Drain
- 2 Integrated Front Access Maintenance Panels
- Color-Matched Extension Kit to Fill to 60"
- Flangeless Design

American Tubs

1274 E Cypress St, Covina, CA 91724

Telephone: 626.581.3588

Fax: 800.943.8652

E-mail: [sales@americantubs.com](mailto:sales@americantubs.com)

© 2019 American Tubs

[AmericanTubs.com](http://AmericanTubs.com)

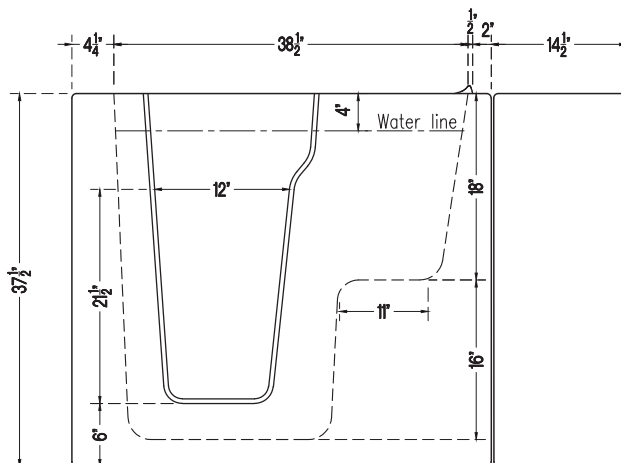
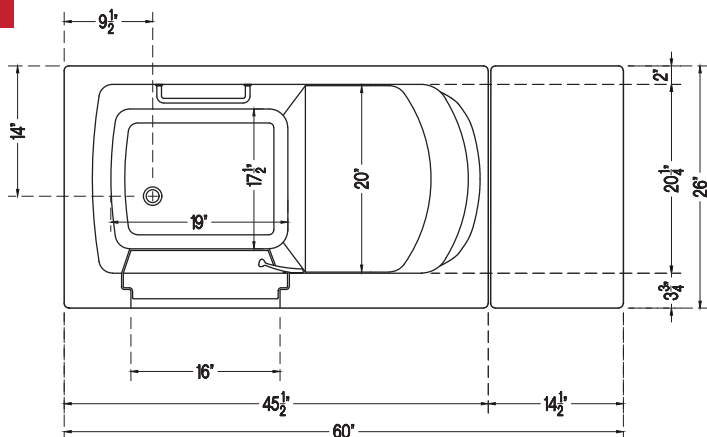

### TUB 2646 SPECIFICATIONS

Tub Dimensions	26" W x 45½" L x 37½" H
Top Diagonal	52½"
Tub Weight	155 lbs.
Crated Dimensions	28" W x 47" L x 48" H
Water Capacity (with user inside approximately)	120 lb. / 40 Gallons 200 lb. / 36 Gallons 250 lb. / 34 Gallons
Seat Dimensions	H: 16"; W: 20"
Door Width	16" (at top)
Door Swing	Inward-Swinging

### DRAIN OPTIONS

1½" Bath Drain & Overflow
2" HurryDrain™
Secondary Emergency Drain
Power Drain

### FAUCET OPTIONS

Elite	4 pcs	Chrome	Modern
Bellevue	5 pcs	Chrome	Modern
Bellevue	5 pcs	Satin/Nickel	Modern
Bellevue	5 pcs	Oil-Rubbed Bronze	Modern
Salutation	5 pcs	Chrome	Classic
Kingston	1 pc	Chrome	Compact

### Hydromassage System Add-Ons & Upgrades

- Leg Massage Only System
- Adjustable Bidet Jet
- Ozone Sanitization System
- Water-Heating Syllent Pump
- Friction Heater
- Inline Heater
- Additional Hip or Knee Jets
- Aromatherapy System

### Optional Accessories

- Chromatherapy Light System
- Heated Seat & Backrest
- Neck Rest Pillow
- Seat Cushion
- L-Shaped Shower Curtain Rod
- Adjustable Shower Slide Bar
- Swinging Glass Shower Door
- Anti-Scald Valve
- Optional Tile Flange Kit
- Additional 12" Extension Kit
- End Panel for Seat and/or Faucet Side
- Bathing Support Harness



Plumbing Safety  
Certified



Electrical Safety  
Certified



Limited Lifetime  
Warranty



Expedited Freight Shipping  
(less than 2 weeks)



1274 E Cypress St, Covina, CA 91724

Telephone: 626.581.3588

Fax: 800.943.8652

E-mail: [sales@americantubs.com](mailto:sales@americantubs.com)

© 2019 American Tubs

